

V01



Cost Report Guide

22nd Formula SAE BRASIL Competition

2026

Topics



General considerations

Cost Report organization

Common mistakes

Cost Addendum

Cost Audit

Understanding your score

General considerations



Important rules:

Formula SAE® Rules 2026

S.3 Cost and Manufacturing Event

Rules Addendum FSAEB 2026

BR.1 Base Rules and Addendum

BR.3.7.3 File Standards

BR.6.3 Cost Event

Cost Event Supplement

The entire document

General considerations



What should be submitted in the Cost Report?

The Cost Report must include the Cost Summary Basics and the BOM summary, as specified in the file provided under [Messages and news](#).

The file must be submitted in **.xlsx** format and must not exceed **200 MB** in size.

Cost Summary Basics

for: University of the Internet
Car # 027

Area Totals	Materials	Processes	Fasteners	Tooling	Total
Brake System	\$ 2,00	\$ 1,00	\$ 0,50	\$ -	\$ 3,50
Drivetrain	\$ 2,00	\$ 2,00	\$ 0,30	\$ -	\$ 4,30
Frame & Body	\$ 2,00	\$ 1,00	\$ 1,00	\$ 1,00	\$ 5,00
Electrical	\$ 2,00	\$ 2,00	\$ 1,00	\$ -	\$ 5,00
Miscellaneous, Finish and Assembly	\$ 0,50	\$ 1,00	\$ 1,00	\$ -	\$ 2,50
Steering System	\$ 0,50	\$ 1,00	\$ 0,50	\$ -	\$ 2,00
Suspension System	\$ 2,00	\$ 3,00	\$ 1,00	\$ -	\$ 6,00
Wheels, Wheel Bearings and Tires	\$ 0,50	\$ 0,50	\$ 1,00	\$ -	\$ 2,00
Total Vehicle	\$ 11,50	\$ 11,50	\$ 6,30	\$ 1,00	\$ 30,30

Composition for total vehicle:

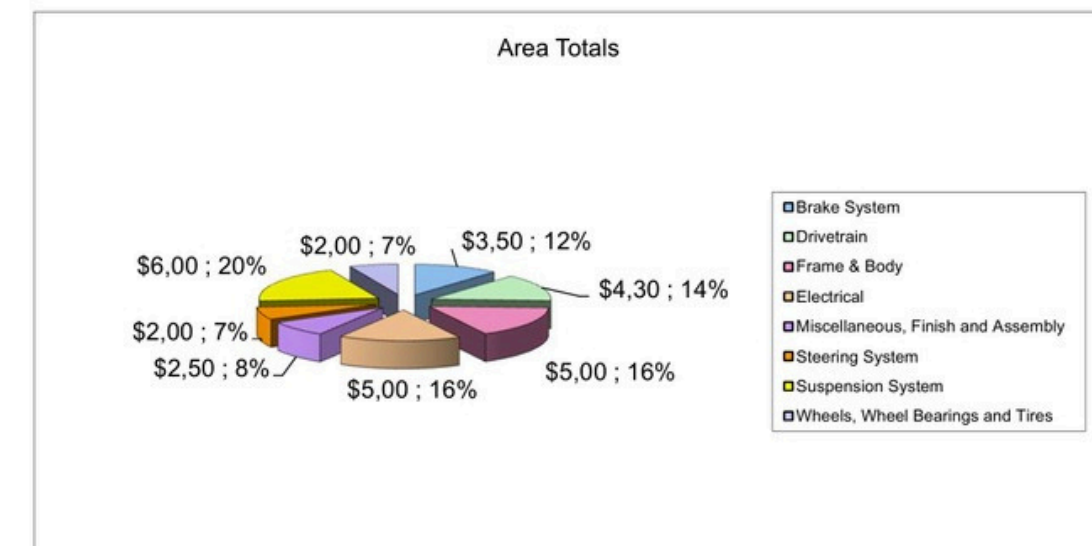

Values for illustrative purposes

Topics



General considerations

Cost Report organization

Common mistakes

Cost Addendum

Cost Audit

Understanding your score

Cost Report organization



Organization tips

When preparing your Cost Report, it is recommended to begin with a cover page, use separate worksheets for each system - as delineated in your BOM - and apply each system's standard color scheme to the worksheets.

The drawings should be placed adjacent to their corresponding parts to facilitate the evaluation of your manufacturing process.

Suggested organization for the Cost Report spreadsheet:

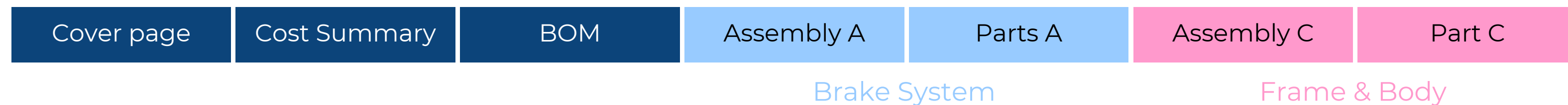

Cost Report organization



Organization tips

It is recommended to include - in an additional worksheet - an organizational chart with hyperlinks arranged hierarchically, listing the assemblies and parts of each system, as exemplified below.

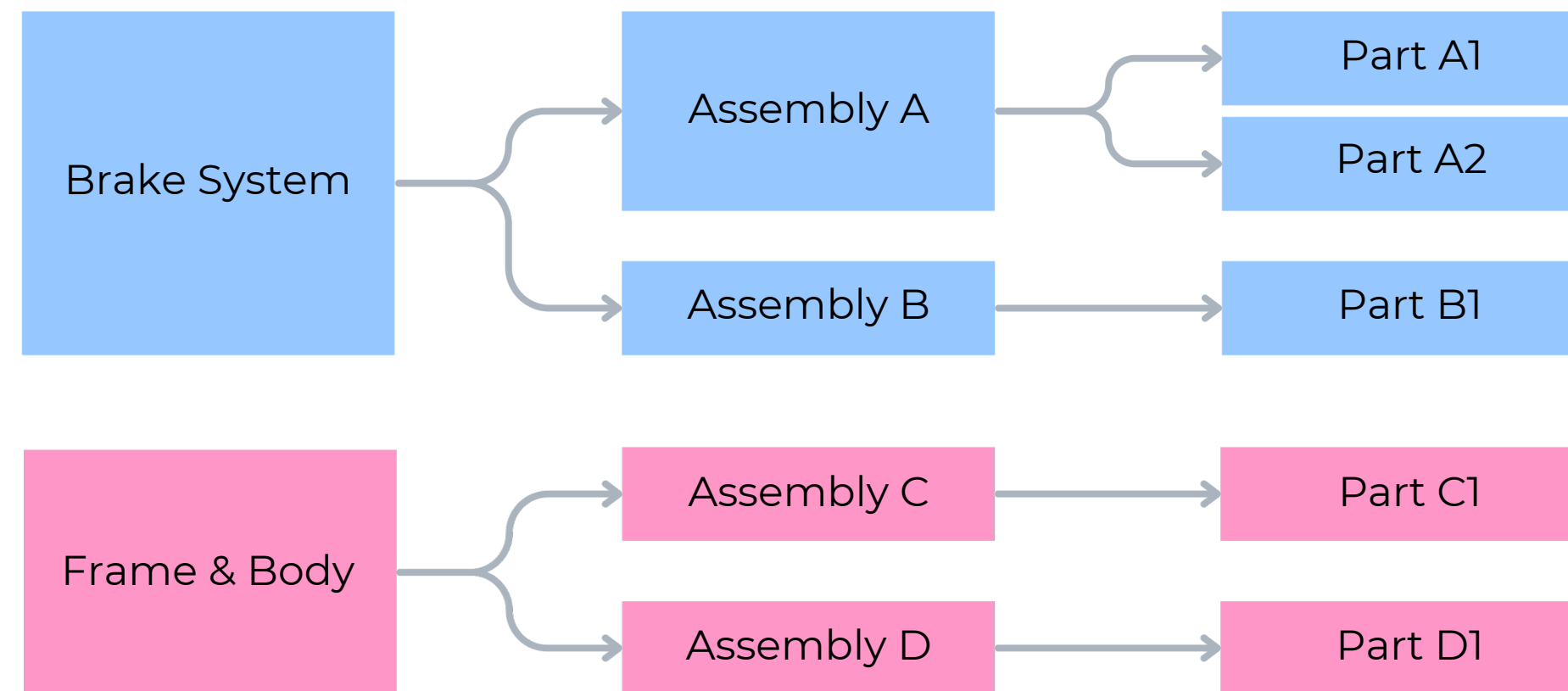

Cost Report Organization



Supporting documentation

Drawings are critical to document how parts are made and an integral part of cost accuracy score. Drawings should have enough details to sufficiently verify part costing (material type, raw material size, finished material size, material remove and tooling size or quantity).

Adding parts to the Cost Catalog

Request the inclusion through the official forum Fsaebrazil.net.

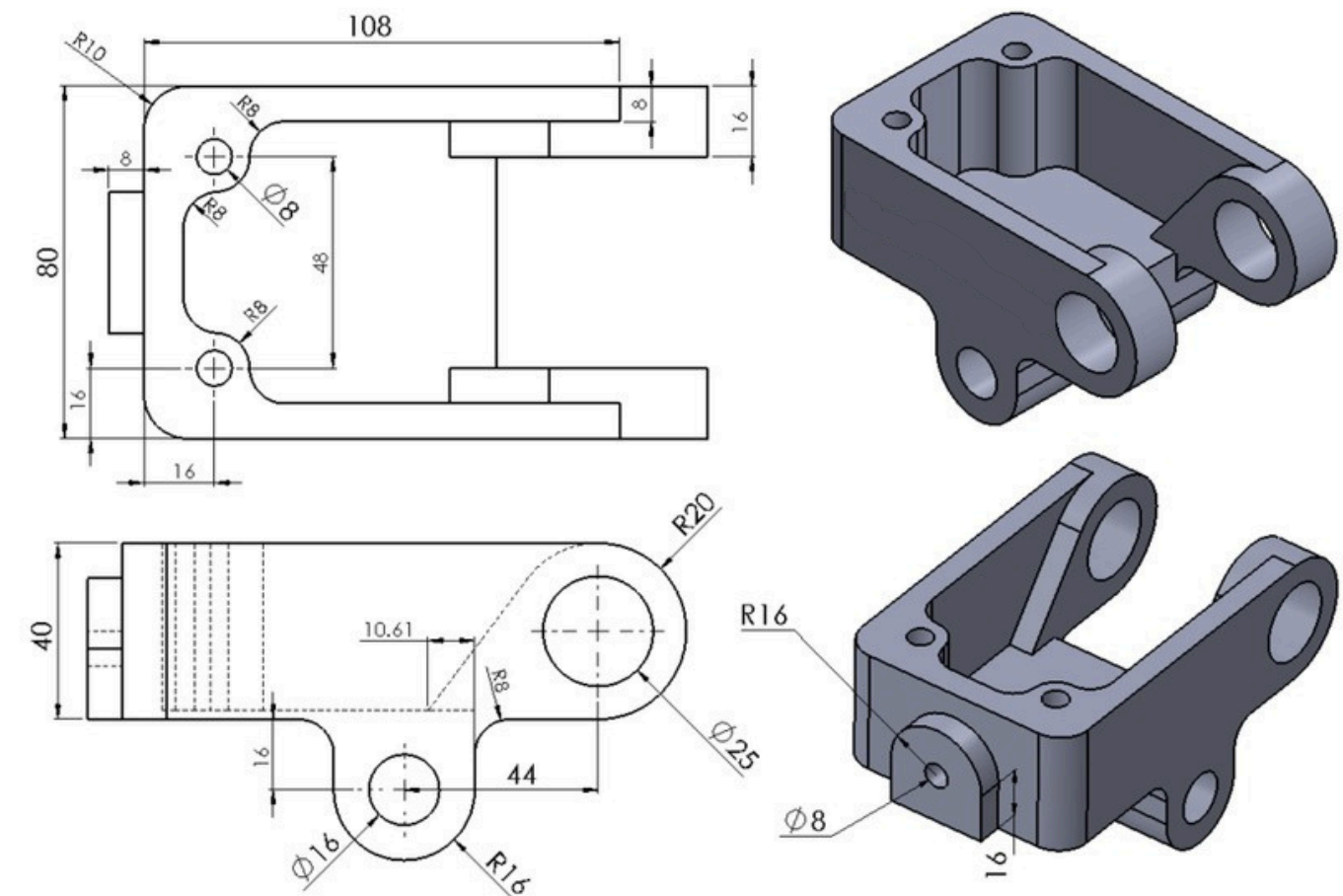

Topics



General considerations

Cost Report organization

Common mistakes

Cost Addendum

Cost Audit

Understanding your score

Common mistakes



Cost Event Supplement

CS.5.b Finishes

CR.4.1 Machining Basis

CR.4.5.1 Machining Setup, Install and Remove

CL Cost Report Systems and Assemblies

Common mistakes observed in previous Cost Audit

Not considering feedback from the last competition in the following year.

Failing to use official information from the Cost Catalogs.

Forgetting to include the tie wrap fastening process.

Including an insufficient amount of silver tape.

Not including fasteners (bolts, nuts and washers) in the correct sizes.

Common mistakes



Cost Event Supplement

CR.4.3 Process Multiplier

Title*	Supplier	Category	
Machining		Material Removal	
Measurement Unit 1 Code	ToolingRequired	Near Net Shape	Process Multiplier Type
cm^3	No	No	Machining

Check Process Multipliers Cost Catalog

Common mistakes



Cost Event Supplement

CR.5.1 Tooling Basis

Title*	Supplier	Category	
Weld		Joining	
Measurement Unit 1 Code	ToolingRequired	Near Net Shape	Process Multiplier Type
cm	Yes	No	

Check Tools Cost Catalog

Topics



General considerations

Cost Report organization

Common mistakes

Cost Addendum

Cost Audit

Understanding your score

Cost Addendum



Rules Addendum FSAEB 2026

BR.3.6 Cost Addendum

Any modification to the original BOM must be documented in the Cost Addendum. It is recommended to submit addendum documents containing all available details necessary to substantiate the modifications.

The Cost Addendum is one of the ways for a team to avoid penalties during the Cost Audit. Therefore, do not wait until the last minute to complete it.

The Cost Addendum must be uploaded online in **.xlsx** format according to **Submission Deadlines**. Use the Cost Addendum template and the form link provided in [Messages and news](#).

Cost Addendum



How to fill out the Cost Addendum?

University _____

Car Number _____

		Reported Section Cost			
	System	Original Total Cost	Revised Total Cost	Raw Difference	Adjusted Difference
1	Brake System			\$ -	\$ -
2	Drivetrain			\$ -	\$ -
3	Frame & Body			\$ -	\$ -
4	Electrical			\$ -	\$ -
5	Miscellaneous, Finish and Assembly			\$ -	\$ -
6	Steering System			\$ -	\$ -
7	Suspension System			\$ -	\$ -
8	Wheels, Wheel Bearings and Tires			\$ -	\$ -
Total		\$ -	\$ -	\$ -	\$ -

Enter the name of the University and the car number. Then, fill in the “Original Total Cost” column with the original costs of each system.

Cost Addendum



How to fill out the Cost Addendum?

University _____ Car Number _____

Reported Section Cost					
	System	Original Total Cost	Revised Total Cost	Raw Difference	Adjusted Difference
1	Brake System			\$ -	\$ -
2	Drivetrain			\$ -	\$ -
3	Frame & Body			\$ -	\$ -
4	Electrical			\$ -	\$ -
5	Miscellaneous, Finish and Assembly			\$ -	\$ -
6	Steering System			\$ -	\$ -
7	Suspension System			\$ -	\$ -
8	Wheels, Wheel Bearings and Tires			\$ -	\$ -
Total		\$ -	\$ -	\$ -	\$ -

Next, fill in the “Revised Total Cost” column with the revised costs for each system. If any system has not undergone any changes, keep the original value.

Cost Addendum



How to fill out the Cost Addendum?

University _____ Car Number _____

		Reported Section Cost			
	System	Original Total Cost	Revised Total Cost	Raw Difference	Adjusted Difference
1	Brake System			\$ -	\$ -
2	Drivetrain			\$ -	\$ -
3	Frame & Body			\$ -	\$ -
4	Electrical			\$ -	\$ -
5	Miscellaneous, Finish and Assembly			\$ -	\$ -
6	Steering System			\$ -	\$ -
7	Suspension System			\$ -	\$ -
8	Wheels, Wheel Bearings and Tires			\$ -	\$ -
Total		\$ -	\$ -	\$ -	\$ -

There is no need to fill in the columns and cells marked in red, as the values will be filled in automatically.

Cost Addendum



How to fill out the Cost Addendum?

Summary of Differences Listed Above - Attach Any Changes					
	<i>System</i>	<i>Assembly</i>	<i>Part</i>	<i>Part # Base</i>	<i>Comments</i>
1					
2					
3					
4					
5					
6					
7					
8					

List and detail the changes indicated in the Reported Section Cost. Remember to attach other documents that support the changes listed in the summary.

Cost Addendum



How to submit the Cost Addendum?

The upload of the Cost Addendum must follow the format bellow:

Cover page

+

Cost Addendum

+

Attachments

#CarNumber



Cost Addendum
University of example

University		University of FSAE		Car Number		99	
Reported Section Cost							
	System	Original Total Cost	Revised Total Cost	Raw Difference	Adjusted Difference		
1	Brake System	\$ 1.747,36	\$ 1.893,00	\$ 145,64	\$ 182,05		
2	Drivetrain	\$ 2.425,13	\$ 2.425,13	\$ -	\$ -		
3	Frame & Body	\$ 3.875,74	\$ 2.425,13	\$ (1.450,61)	\$ (1.087,96)		
4	Electrical	\$ 2.345,00	\$ 2.345,00	\$ -	\$ -		
5	Miscellaneous, Finish and Assembly	\$ 276,50	\$ 276,50	\$ -	\$ -		
6	Steering System	\$ 365,76	\$ 365,76	\$ -	\$ -		
7	Suspension System	\$ 3.400,25	\$ 3.400,25	\$ -	\$ -		
8	Wheels, Wheel Bearings and Tires	\$ 1.150,50	\$ 1.150,50	\$ -	\$ -		
Total		\$ 15.586,24	\$ 14.281,27	\$ (1.304,97)	\$ (905,91)		

Summary of Differences Listed Above - Attach Any Changes					
	System	Assembly	Part	Part # Base	Comments
1	Brakes	Front Brake Assembly	Brake Bobbins	P1004	changed material of brake bobbins from aluminum to titanium
2	Frame & Body	Aerodynamics Assembly	Undertray	P3004	removed undertray
3					
4					
5					
6					
7					
8					

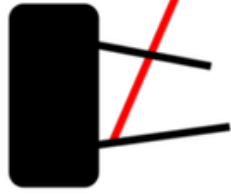
From: 

To: 

CReBOM
Attachments

Topics



General considerations

Cost Report organization

Common mistakes

Cost Addendum

Cost Audit

Understanding your score

Cost Audit



Rules Addendum FSAEB 2026

BR.6.3.2 Vehicle condition

BR.6.3.3 Delays

It is recommended that teams be present at the entrance of static events area at least 10 minutes in advance, with the spreadsheet open on their laptop or tablet.

The presentation of the Cost Report must be carried out using the spreadsheet (in **.xlsx** format) that corresponds with the Cost Addendum. During the presentation, the Cost Judges will review whether the Cost Report accurately reflects the vehicle as presented and will apply penalties for any missing or incorrect information when compared to the vehicle inspected.

Tip! Simulate the Cost Audit in advance of the competition and select team members who are familiar with the spreadsheet to present it.

Topics



General considerations

Cost Report organization

Common mistakes

Cost Addendum

Cost Audit

Understanding your score

Understanding your score



Rules Addendum FSAEB 2026

BR.6.3.1 Evaluation areas

Area	Score
Cost (not presented)	40
BOM	25
Manufacturing Feasibility	25
Real Case	30
Total	120

To explain the scoring process, let us consider 5 teams that submitted their Cost Report by the deadlines established in the Submission Deadlines, meaning they will not incur penalties for late submission.

Understanding your score



Cost (not presented)

Team	Original Cost	Cost after Cost Addendum
Team A	\$ 14.000,00	\$ 14.000,00
Team B	\$ 15.000,00	\$ 14.750,00
Team C	\$ 16.000,00	\$ 16.200,00
Team D	\$ 17.000,00	\$ 16.850,00
Team E	\$ 18.000,00	\$ 18.000,00

Teams B, C and D submitted the Cost Addendum. Consequently, the Cost is updated to the value indicated in the addendum documents.

Teams A and E did not submit the Cost Addendum. Thus, the Cost remains unchanged.

Values for illustrative purposes

Understanding your score



Cost (not presented)

Team	Original Cost	Cost after Cost Addendum	Penalties (S.3.12)
Team A	\$ 14.000,00	\$ 14.000,00	15
Team B	\$ 15.000,00	\$ 14.750,00	3
Team C	\$ 16.000,00	\$ 16.200,00	0
Team D	\$ 17.000,00	\$ 16.850,00	1
Team E	\$ 18.000,00	\$ 18.000,00	18

Values for illustrative purposes

Notice that Teams A and E received additional penalties because they presented missing or incorrect information when compared to the vehicle inspected during the Cost Audit.

Learn more about the penalties at:

Formula SAE® Rules 2026

S.3.12 Cost Report Penalties Process

Penalties incurred during the Cost Audit will be deducted from the total Cost Event score, as well as penalties related to Submission Delay, Submission Format and Submission Content.

Understanding your score



Cost (not presented)

Team	Original Cost	Cost after Cost Addendum	Cost after Committee evaluation (S.3.12.3)
Team A	\$ 14.000,00	\$ 14.000,00	\$ 14.500,00
Team B	\$ 15.000,00	\$ 14.750,00	\$ 14.800,00
Team C	\$ 16.000,00	\$ 16.200,00	\$ 16.200,00
Team D	\$ 17.000,00	\$ 16.850,00	\$ 16.860,00
Team E	\$ 18.000,00	\$ 18.000,00	\$ 18.800,00

Values for illustrative purposes

After the Cost Audit, teams have their Cost values corrected (S.3.12.3).

These values will be used to calculate the vehicle Cost Score according to the formula below:

$$\text{Cost Score} = 40 * \frac{C_{\text{max}} - C_{\text{your}}}{C_{\text{max}} - C_{\text{min}}}$$

Understanding your score



Cost (not presented)

Team	Cost after Committee evaluation (S.3.12.3)	Cost Score
Team A	\$ 14.500,00	40
Team B	\$ 14.800,00	37,2
Team C	\$ 16.200,00	24,2
Team D	\$ 16.860,00	18
Team E	\$ 18.800,00	0

Calculating the Cost Score for Team B.

$C_{your} = \$ 14.800,00$

$C_{min} = \$ 14.500,00$

$C_{max} = \$ 18.800,00$

$$\text{Cost Score} = 40 * \frac{18800 - 14800}{18800 - 14500}$$

Cost Score = 37,2

Values for illustrative purposes

Understanding your score



Rules Addendum FSAEB 2026

BR.6.3.1 Evaluation areas

Area	Score
Cost (not presented)	40
BOM	25
Manufacturing Feasibility	25
Real Case	30
Total	120

Meanwhile, the BOM score is based on the quality of your Cost Report, compliance with the rules, drawings that facilitate understanding of the manufacturing processes of the parts, ease of finding information, among other aspects.

V01



Cost Report Guide

22nd Formula SAE BRASIL Competition

2026